

RA 701 B
Batterie assembling as from machine no. 9016/001

As at: 10/12/11 Time:08:40

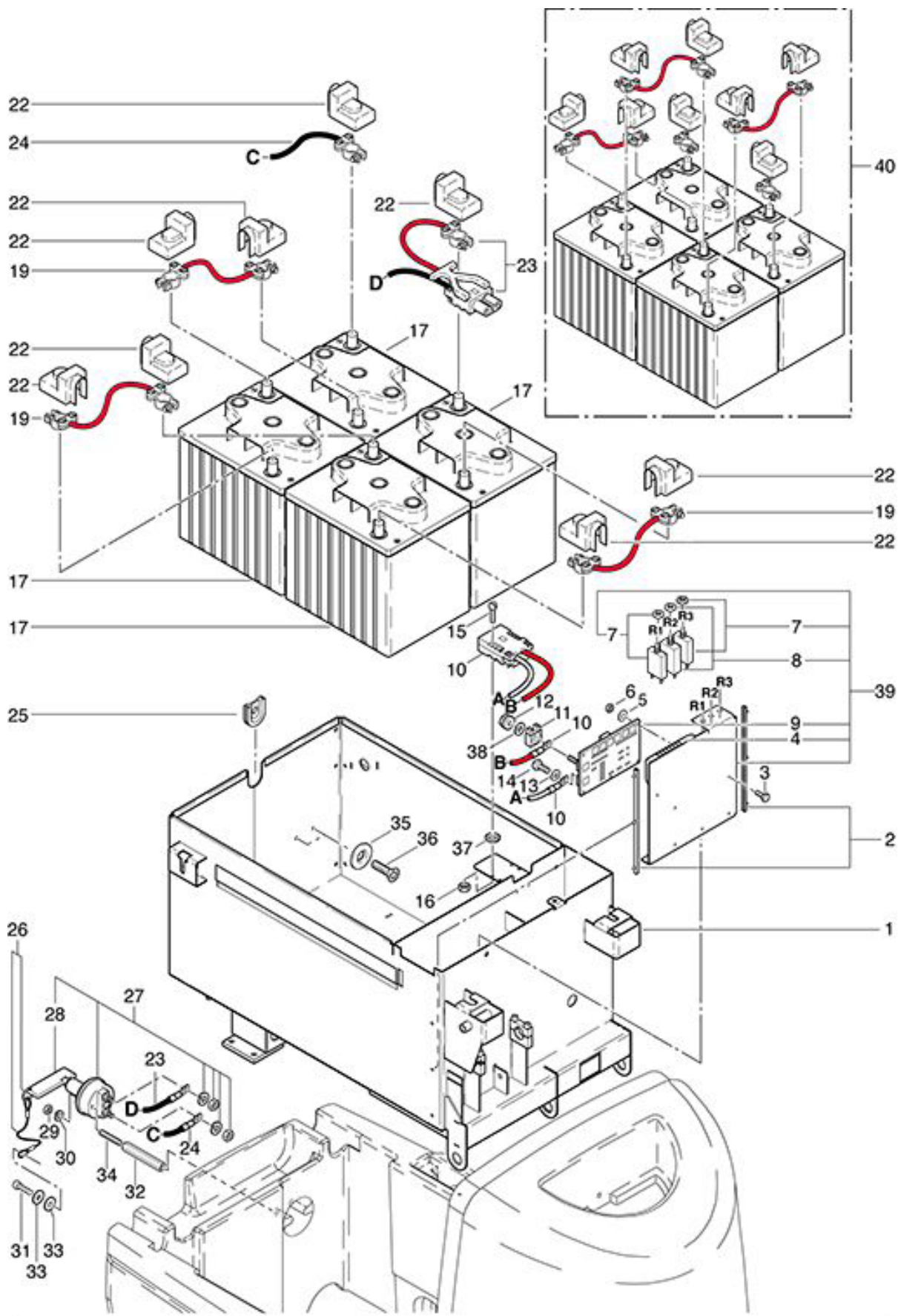

RA 701 B

Batterie assembling as from machine no. 9016/001

As at: 10/12/11 Time:08:40

Pos.	Description	Reference
01	Battery container	701.210
02	Guide rail	710.356
03	Hexagon screw M 6x12	P...486 B
04	Control Curtis	701.342
05	Washer	P...497 C
06	Nut M 6	P...491 L
07	Protective switchgear 25 A	470.355
08	Protective switchgear 45 A	470.711
09	Electronic support	701.341 A
10	Cable compl. 80A	701.356
11	Fuse 100 Amp.	710.354
12	Isolation nut M 8	710.353
13	Washer M 5	P...496 H
14	Chees-head screw M 4x8	P...475 H
15	Chees-head screw M 4x25	P...477 H
16	Nut M 4	P...491 H
17	Batterie	701.091
18	Connecting cable set	710.620
19	Battery connecting cable	560.995
22	Pol cover	P...357 D
23	Cable compl. 80A	701.352
24	Wiring black Ø 10 mm	701.351
25	Cable thorough	030.014
26	Packthread	710.612
27	Partition plug for battery compl.	710.611
28	Key	710.613
29	Security nut M 6	P...492
30	Washer M 6	P...498 U
31	Cylindrical screw M 6x12	P...486 Q
32	Distance owner M 6x60	P...484 UA
33	Washer M 6	P...497 K
34	Thread pin I-6kt. M 6x25	P...513 K
35	Washer M 6	P...500 Q
36	Counter sunk srew 6 edge M 6x16	P...487 W
37	Lock washer	P...498 B
38	Washer M 10	P...500 S
39	Electrical NIC unit compl. inclusive pos. 4,7,8+9	701.340
40	Complete set of batteries 6V/180Ah	701.650